



INNOVATIVE HEALTHCARE REAL ESTATE, A TWG AFFILIATE



Indiana American One

555 E County Line Road, Greenwood, IN

PROPERTY SQUARE FEET: 54,303

RENTAL RATE: \$17.00-\$20.00 / RSF Modified Gross

VACANT SQUARE FEET: 12,669 RSF

Suite 106: 900 RSF (1st Floor)

Suite 105: 3,512 RSF (1st Floor)

Suite 104: 8,257 RSF (1st Floor)

CONTACT:



Tyson C. Chastain

317.653.5626 | tyson@thinkinnovcare.com

PROPERTY DESCRIPTION:

The Property is a two story mixed use office building. The Property has an office and medical office tenant mix. The building is located conveniently off of County Line Rd. between two major retail districts and hospital campuses (Community Health and St. Francis Health). The building tenant mix consists of one large office user and two medical practices (Midwest Eye and Community Health). The property parking is adequate for an office use and medical use. The three vacant suites available are on the first floor. The suites can be demised.





INNOVATIVE HEALTHCARE REAL ESTATE, A TWG AFFILIATE

Suite 106

RENTABLE SQUARE FEET: 900

CONDITION OF SUITE: 2nd Generation Office Space

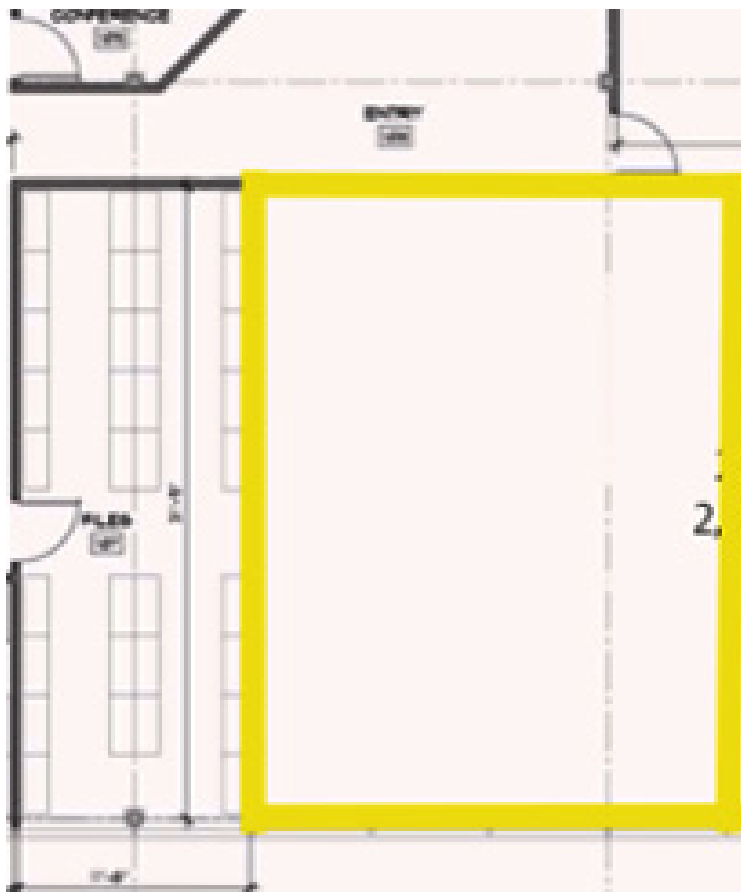



INNOVATIVE HEALTHCARE REAL ESTATE, A TWG AFFILIATE

Suite 105

RENTABLE SQUARE FEET: 3,512

CONDITION OF SUITE: 2nd Generation Office Space





INNOVATIVE HEALTHCARE REAL ESTATE, A TWG AFFILIATE

Suite 104

RENTABLE SQUARE FEET: 8,257

CONDITION OF SUITE: 2nd Generation Education Space

